

## 20' x 15' Salon Specifications

### SALON BOOTH PACKAGE INCLUDES:

**Showcase Options:** Two (2) 2M Towers  
Two (2) 1M Towers  
Two (2) 2M Low  
One (1) 2M Tower and One (1) 1M Tower  
One (1) 2M Tower and One (1) 2M Low

- Four (4) Wastebaskets
- Twelve (12) Wynn Hotel Ballroom Chairs
- Four (4) Tables (*please complete the Salon Package Table Order Form by May 5, 2025*)
- Four (4) Track Lighting Bars with three (3) 6000K LED 12 watt fixtures each
- Electrical for the showcases and the lights in each booth will be included. Any other items requiring electricity in the Salons will require an electrical order to be placed with Freeman. Please refer to the Freeman Electrical Order Form.
- Custom sign plaque with company name and booth number in Couture Type font
- One time vacuuming prior to show opening
- Daily trash removal (*please leave your wastebasket outside your booth at close of show each day*)

Note: For 2M low showcases only, in addition to track in center, one (1) track with three (3) lights hung behind sign plaque above low showcase will be added.

**Salon Size:** Salon measures 20' (6.10M) wide x 15' (4.57M) long x 8' (2.44M) high.  
Please see internal exhibit dimensions on attached renderings.

**Color:** Exterior walls are Morris Oak Wood Laminate. Interior walls are Light Gray Laminate.

**Decorating Interior of Salons:** All materials or adhesives must be removed from panels, showcase shelves and showcase doors at close of show. Any remaining materials or adhesives will be removed at an additional labor cost to the exhibitor.

### PLEASE NOTE:

- **There is a weight limit of 50 lbs. for each 1M wall panel.**
- **For stability, no additional lights can be added to the sign light track.**

**Freeman will provide two (2) design renderings at No Charge for Salon customizations or changes. Additional revisions will be charged at \$250.00 each.**

**All salon structure changes and/or customizations must be finalized by April 18, 2025 or surcharges will apply. Changes made after May 9, 2025 will incur 30% surcharge. No additional changes allowed May 10, 2025 though show open. On May 10, 2025, your salon will be ordered at the package you purchased through COUTURE management.**

Please contact [CoutureSales@freeman.com](mailto:CoutureSales@freeman.com) to discuss further customizing your space.

# 20 x 15 INLINE SALON

## 2M Towers Option

44"x12" ID Sign

Light Gray Laminate

Morris Oak Wood Laminate



12 Track Lights

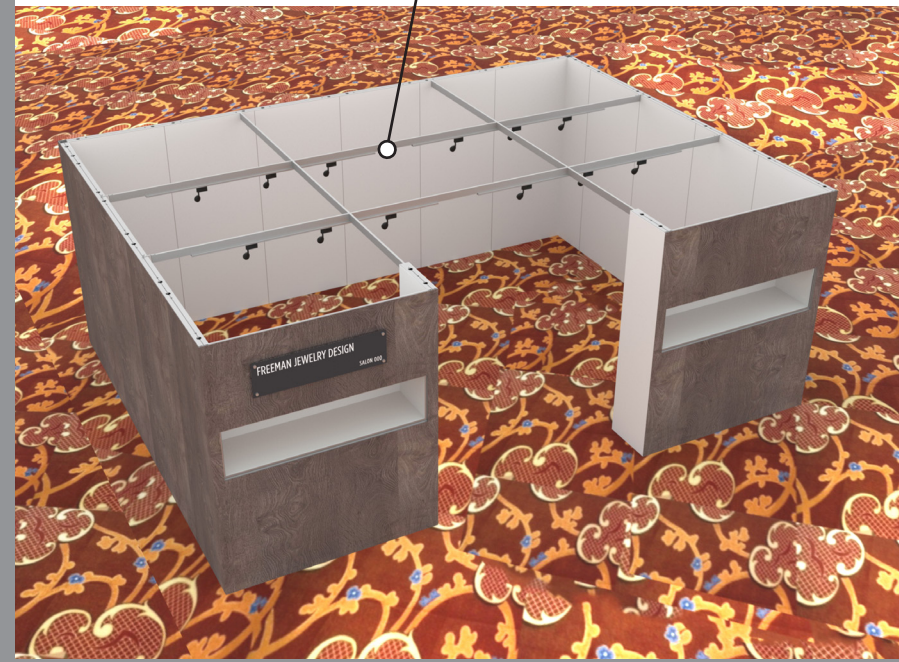

Towers have LED lights integrated

# 20x15 - 2M Towers Option

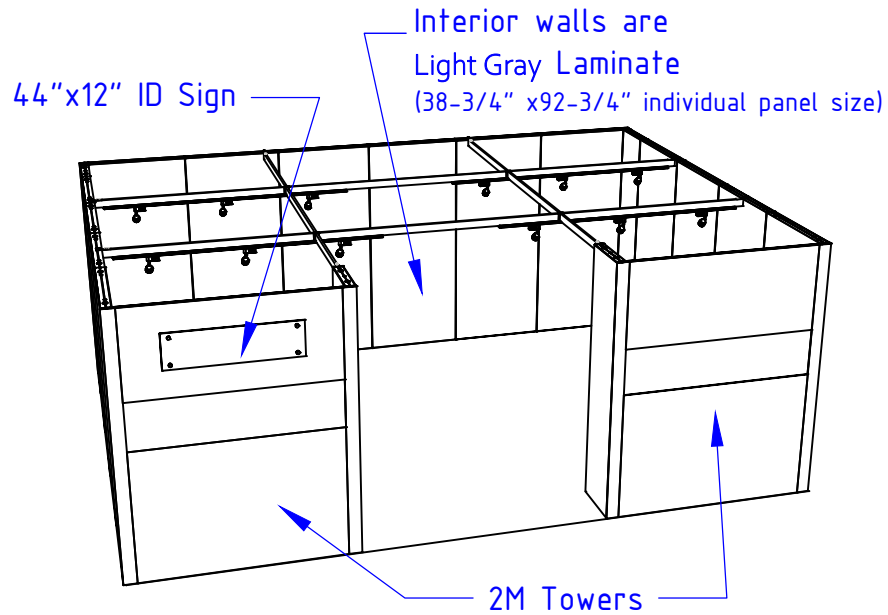

PERSPECTIVE - FRONT

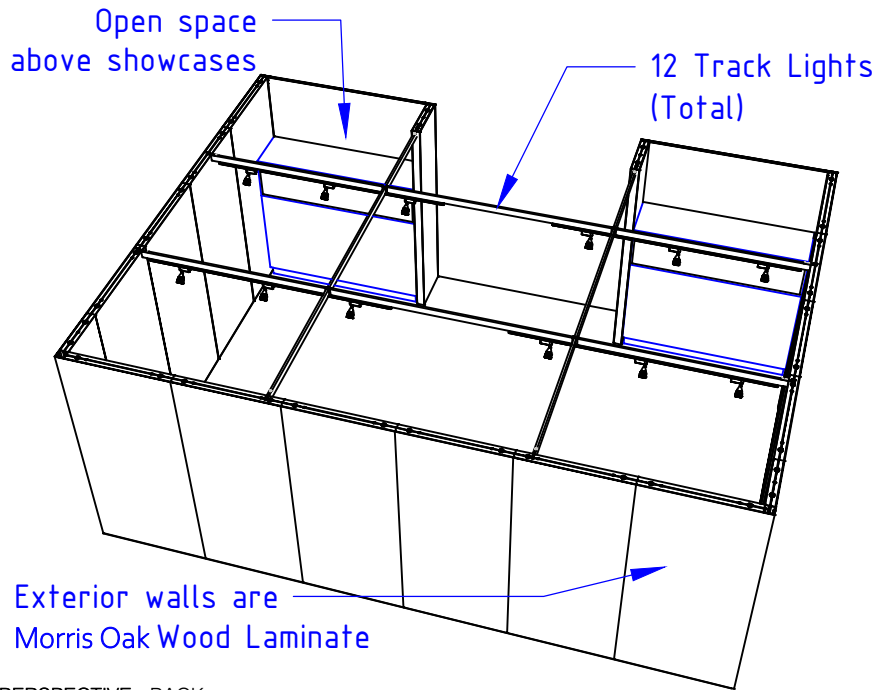

PERSPECTIVE - BACK

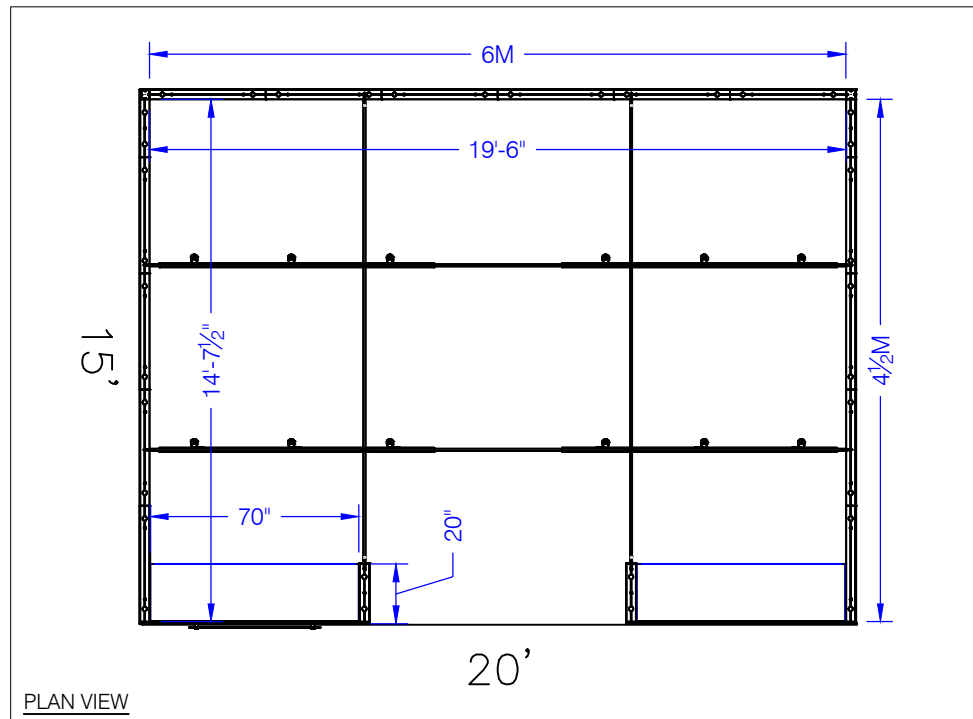

PLAN VIEW

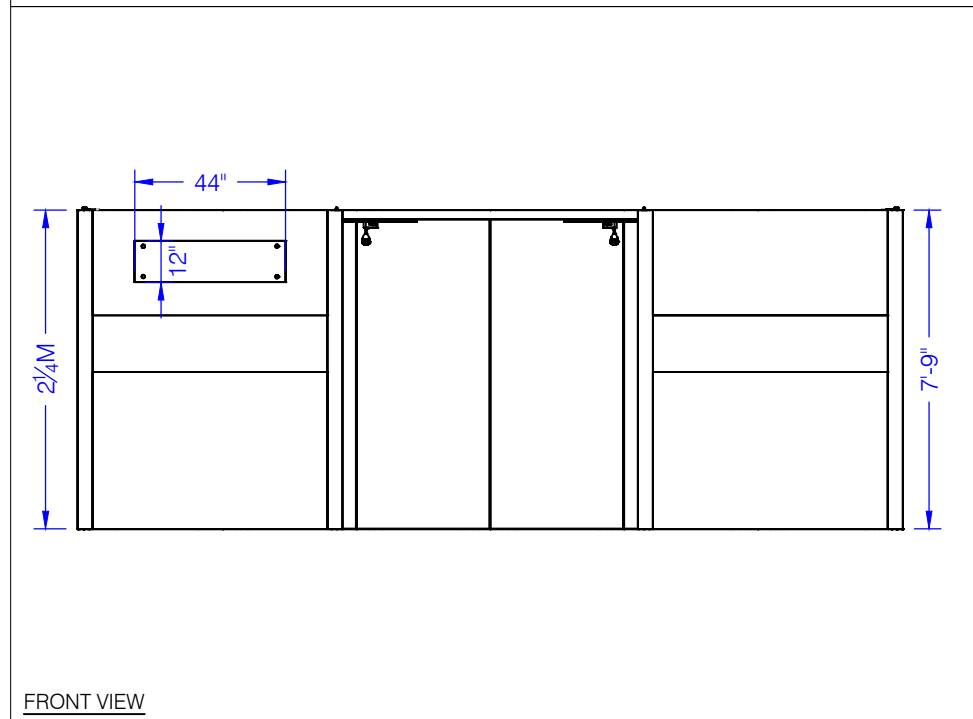

FRONT VIEW

# 20 x 15 INLINE SALON

## 1M Towers Option

44"x12" ID Sign

Light Gray Laminate

Morris Oak Wood Laminate

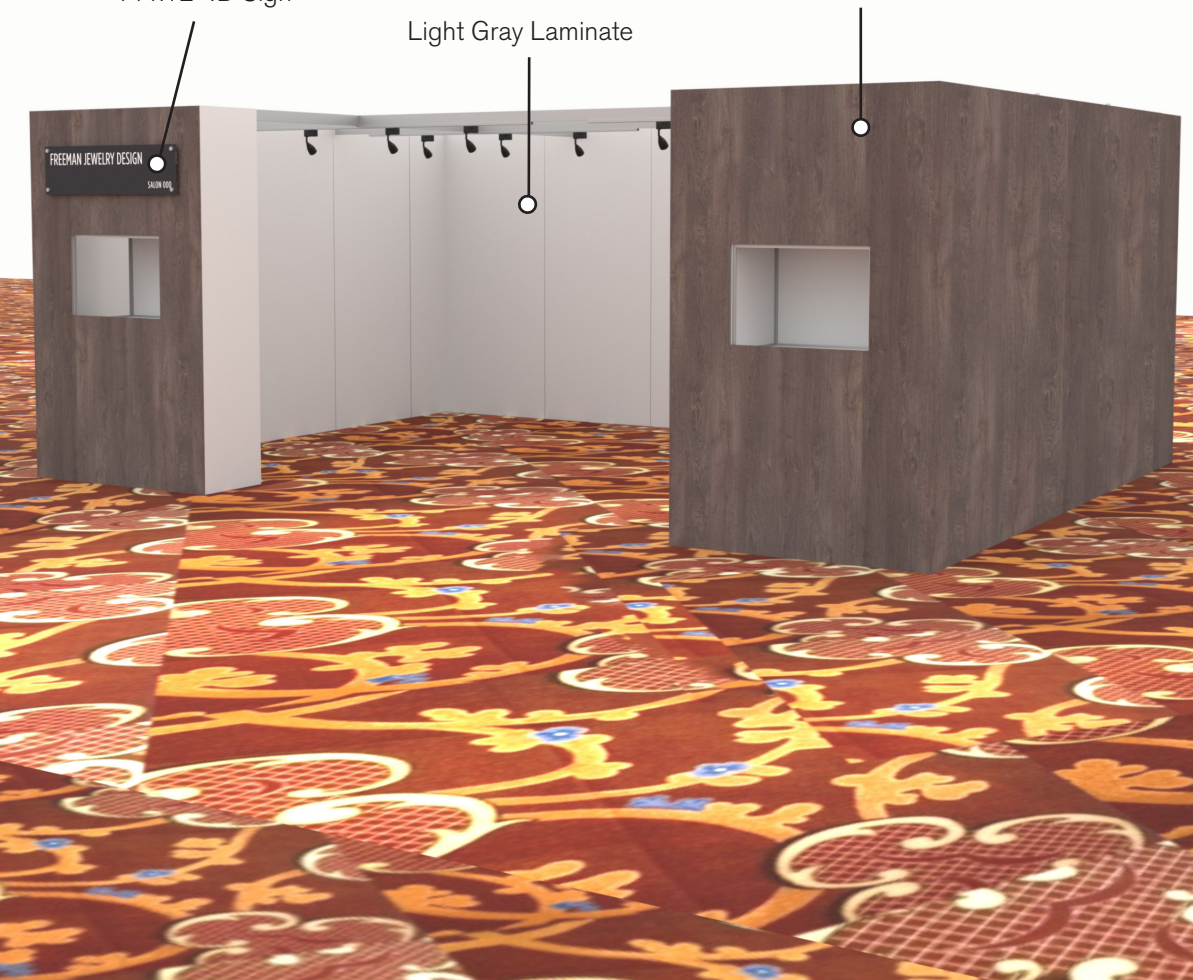

12 Track Lights

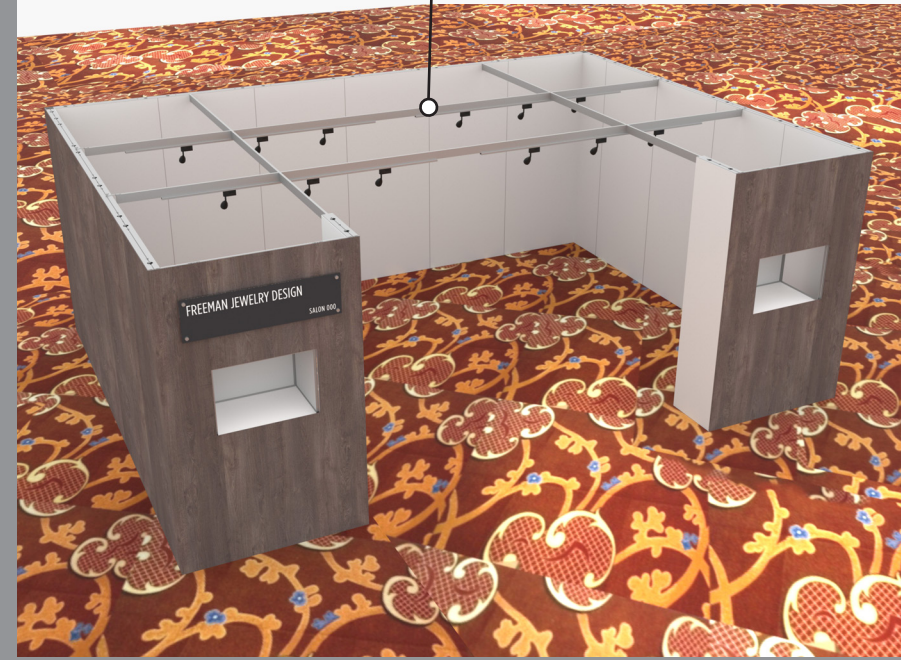

Towers have LED lights integrated

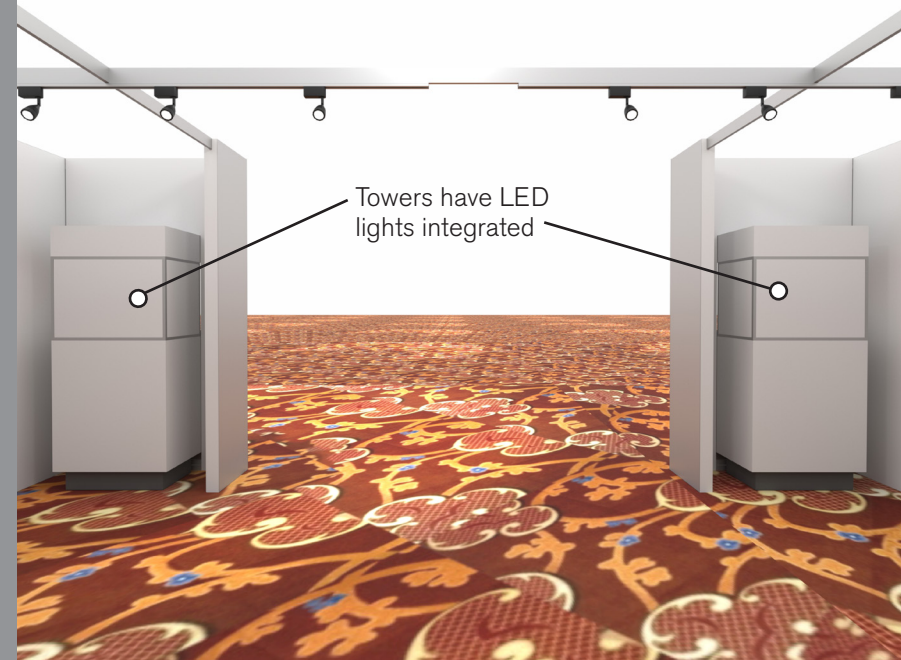

# 20x15 1M Towers Option

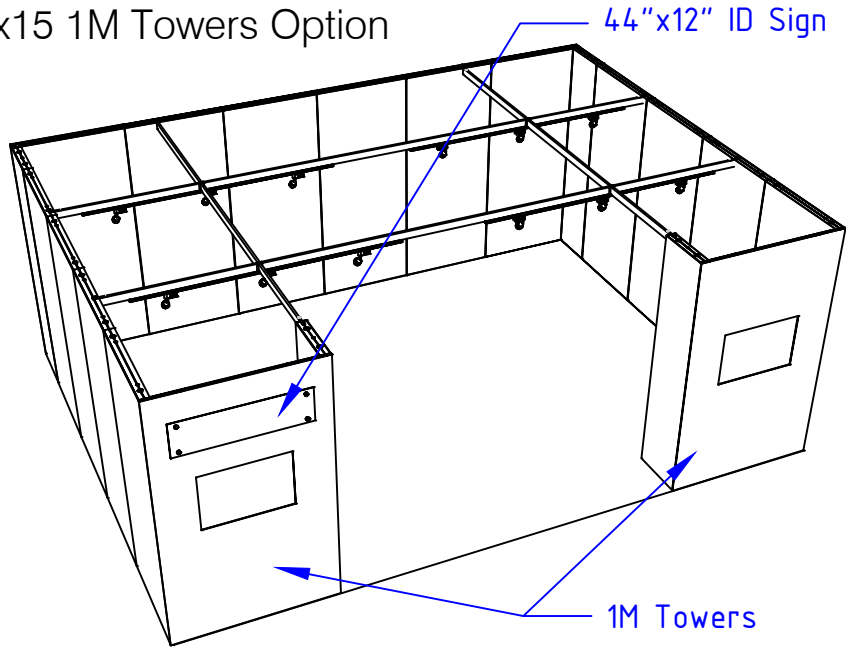

PERSPECTIVE - FRONT

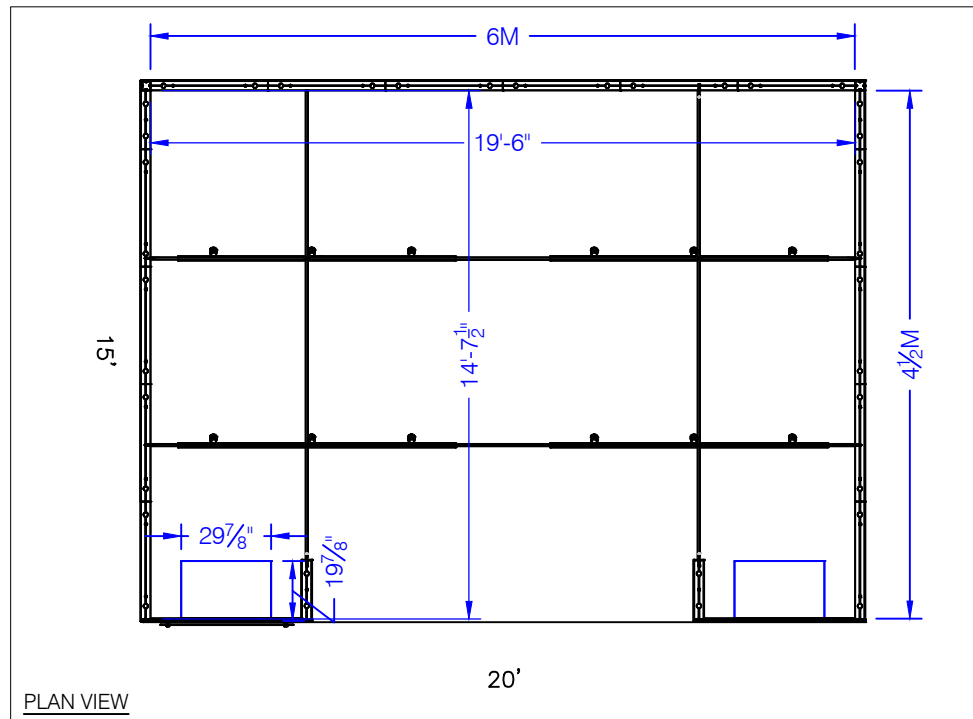

PLAN VIEW

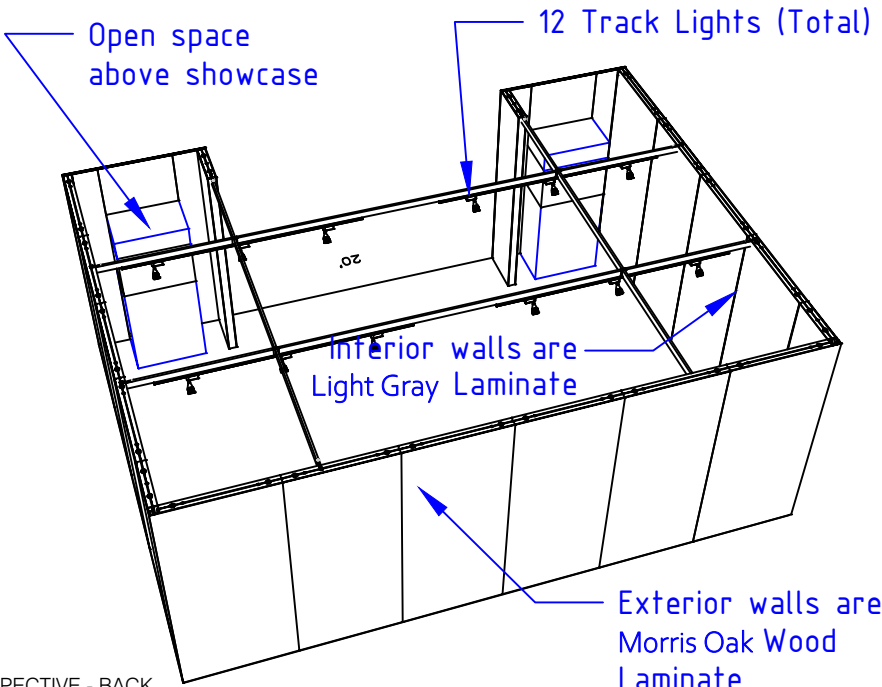

PERSPECTIVE - BACK

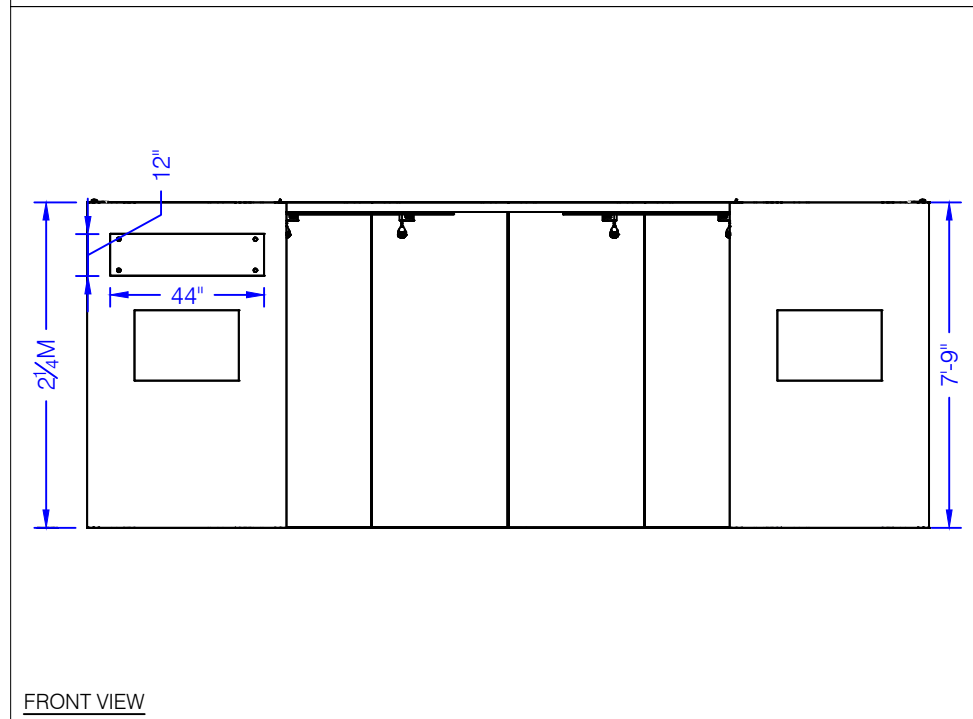

FRONT VIEW

# 20 x 15 INLINE SALON

## 2M Low Showcases Option



8 Track Lights

44"x12" ID Sign  
(There are 3 lights behind each sign)

Light Gray Laminate



Morris Oak  
Wood Laminate

Showcases have  
LED lights integrated

# 20x15 2M Showcases Option

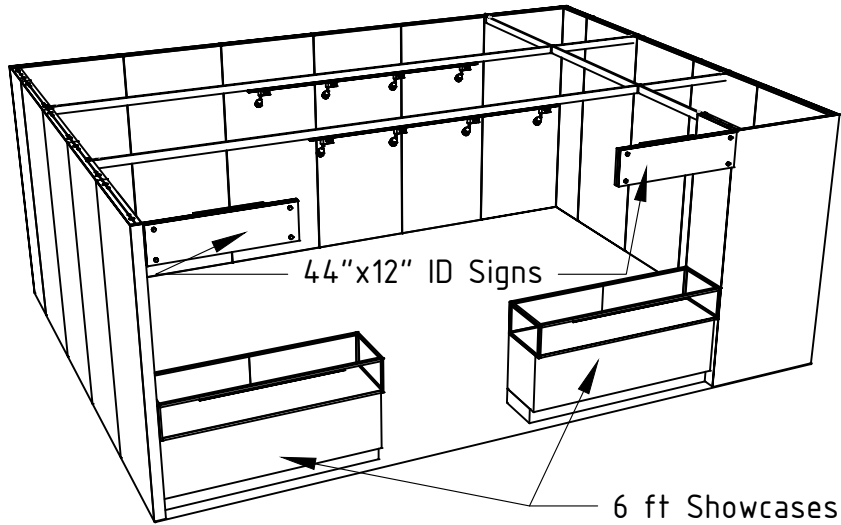

PERSPECTIVE - FRONT

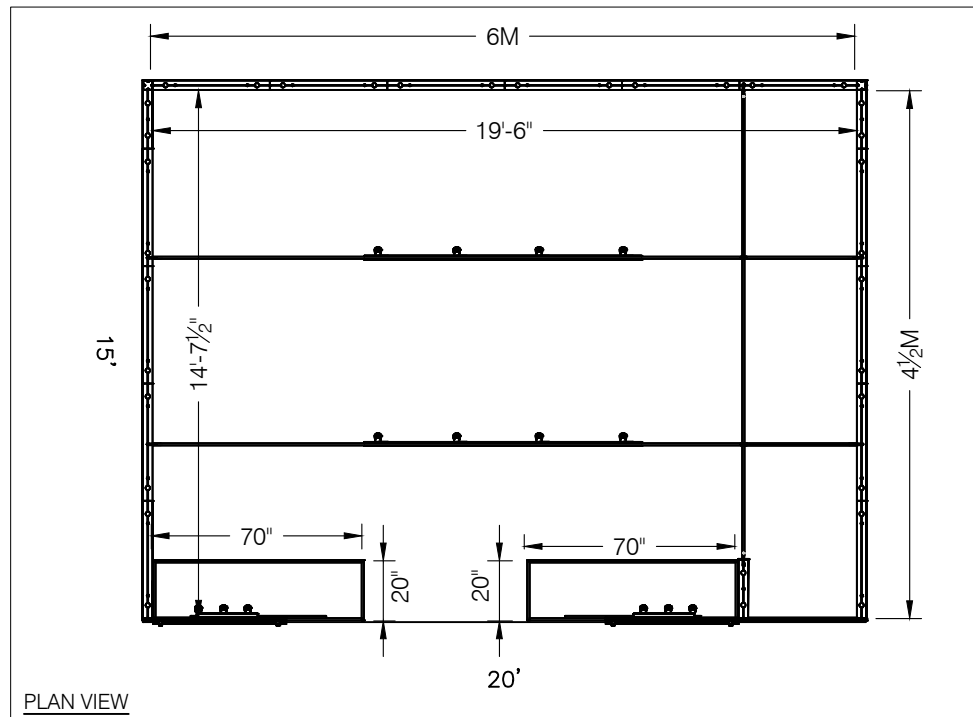

PLAN VIEW

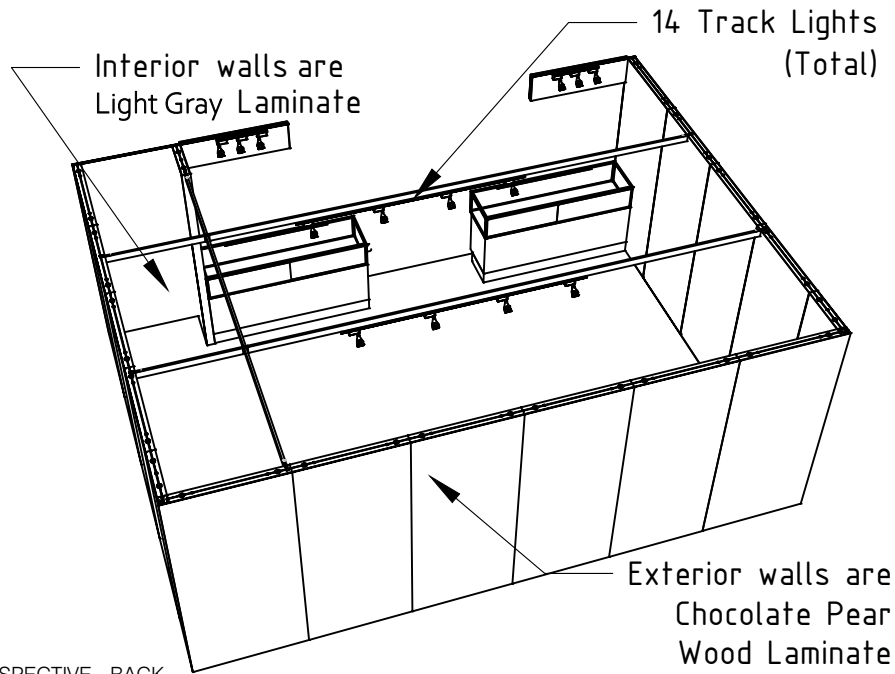

PERSPECTIVE - BACK

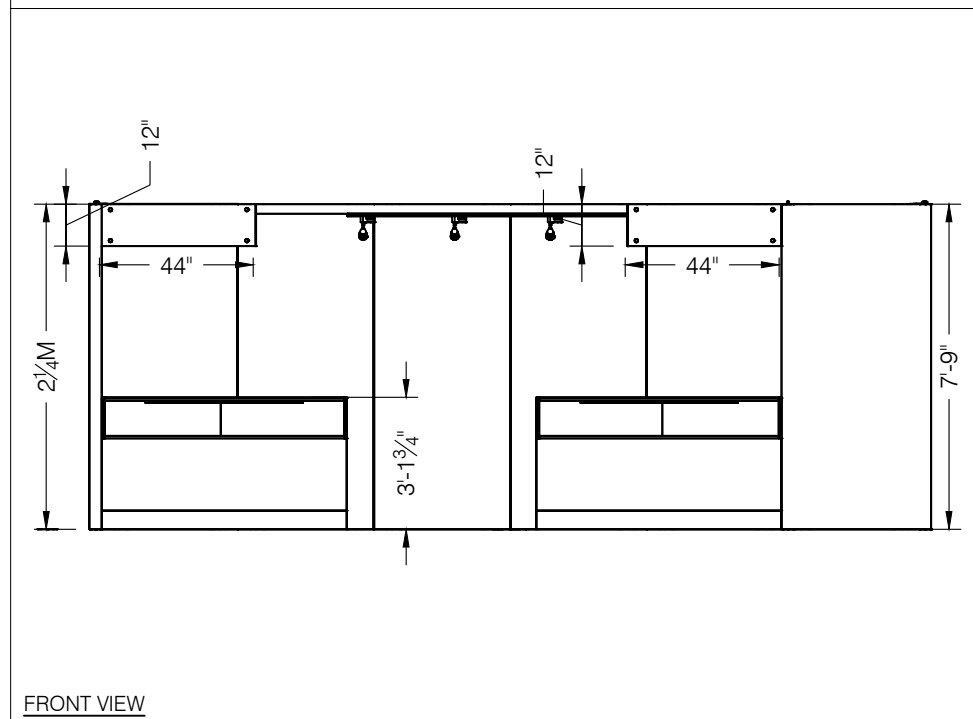

FRONT VIEW

# 20 x 15 INLINE SALON

1M Tower and 2M Tower Option

8 Track Lights

44"x12" ID Sign

Light Gray Laminate

Morris Oak Wood Laminate

Showcases have LED lights integrated





20x15 - 2M Tower and 1M Tower Option

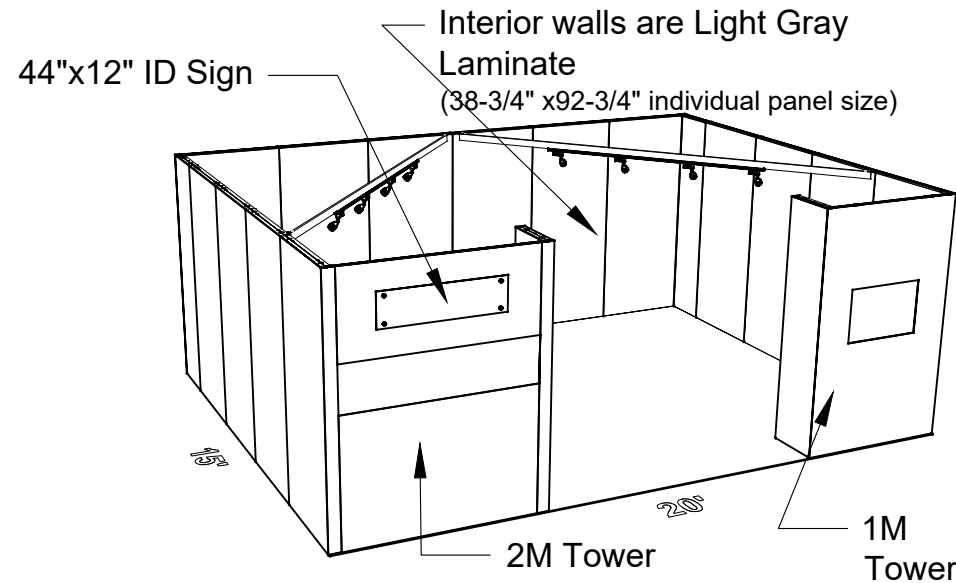

PERSPECTIVE - FRONT

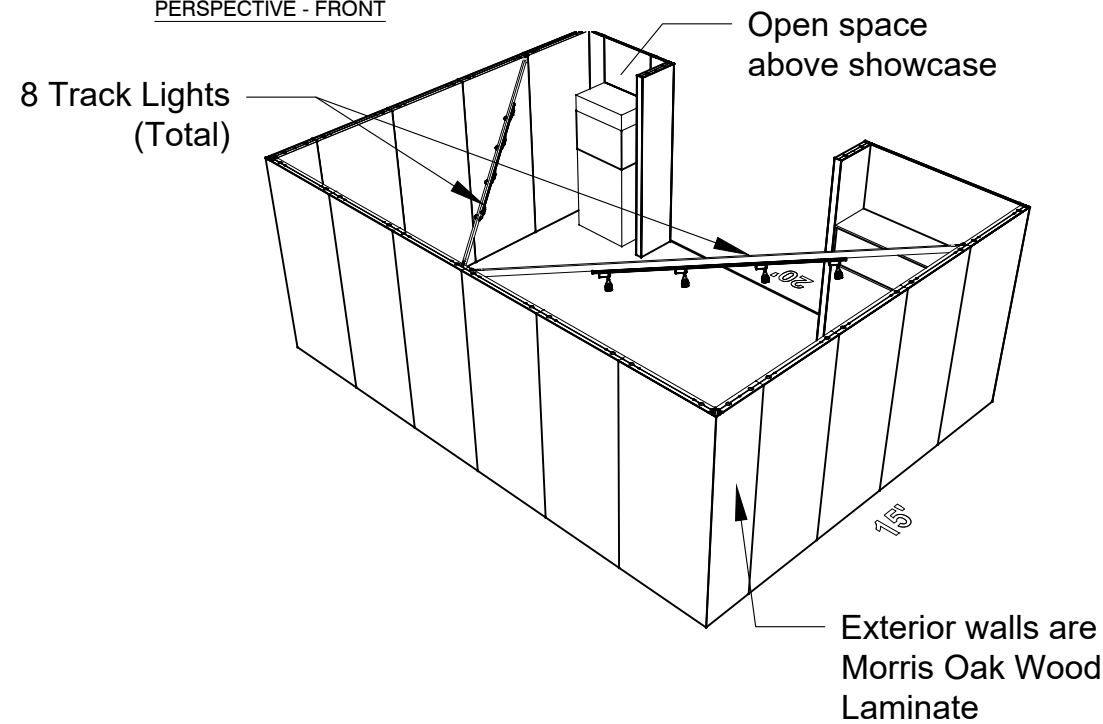

PERSPECTIVE - BACK

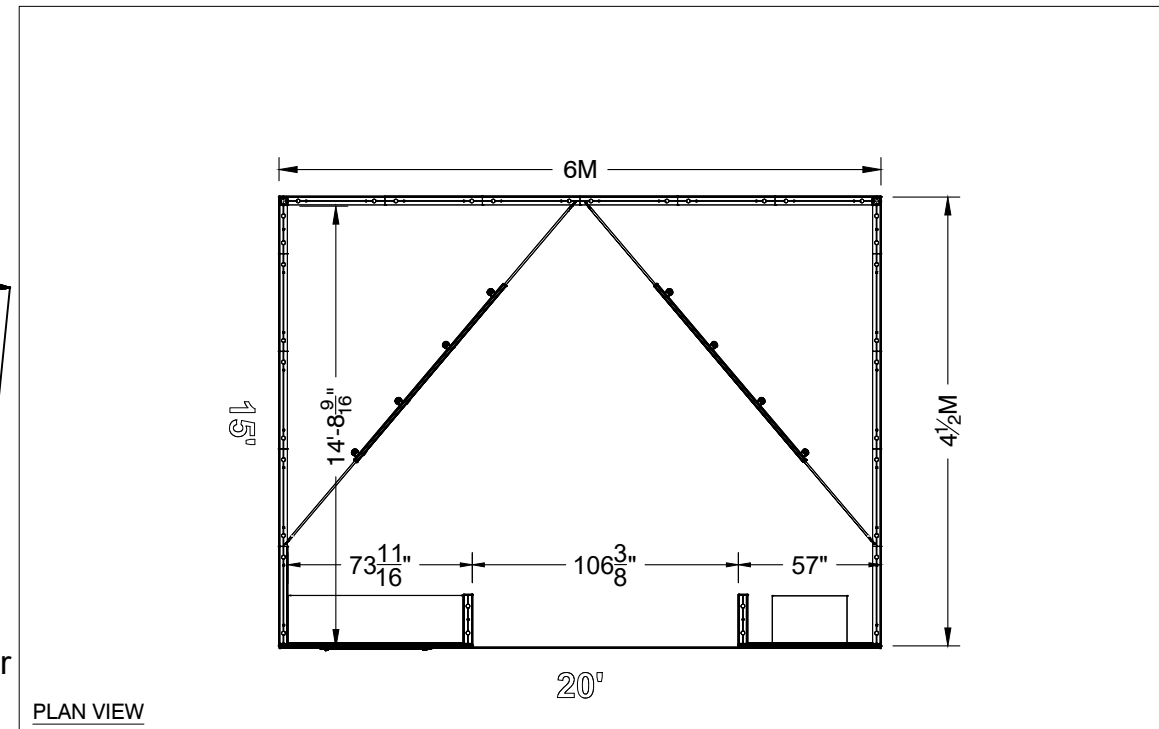

PLAN VIEW

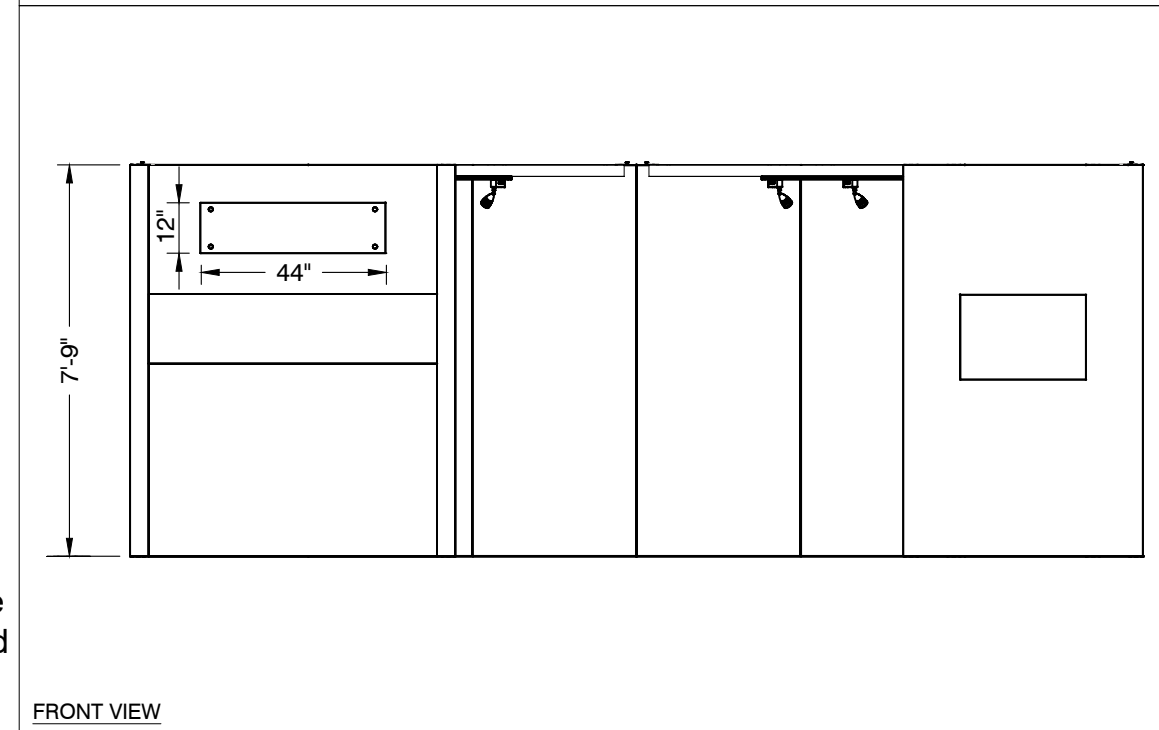

FRONT VIEW

LESS THAN 30 DAYS OUT

\* 0 0 5 0 5 9 0 7 0 1 . 1 0 1 1 . 0 \*

MORE THAN 30 DAYS OUT

\* 0 0 5 0 5 9 0 7 0 1 . 1 0 1 1 . 1 \*

# 20 x 15 INLINE SALON

## 2M Tower and Low Showcase Option

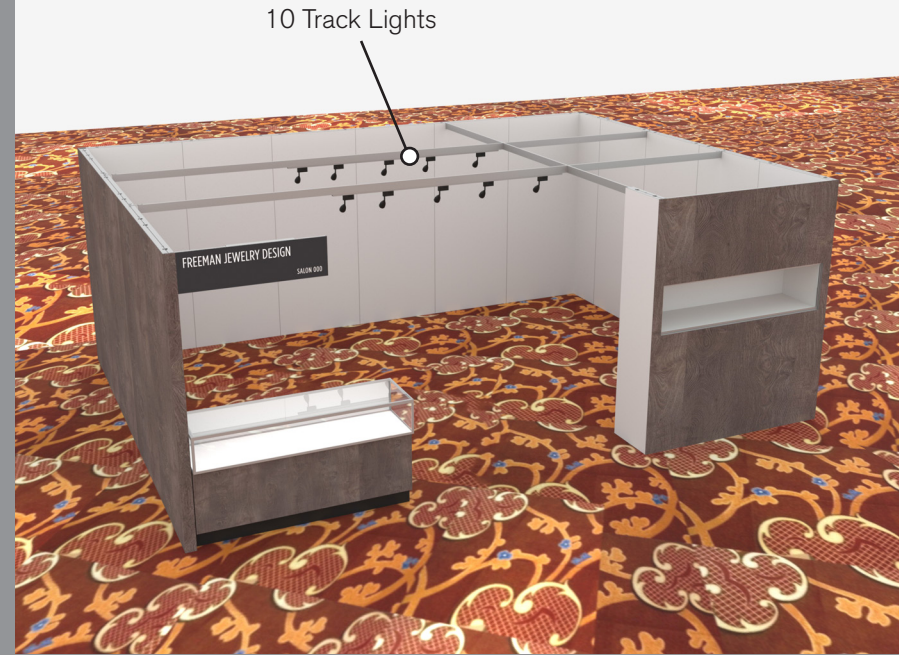
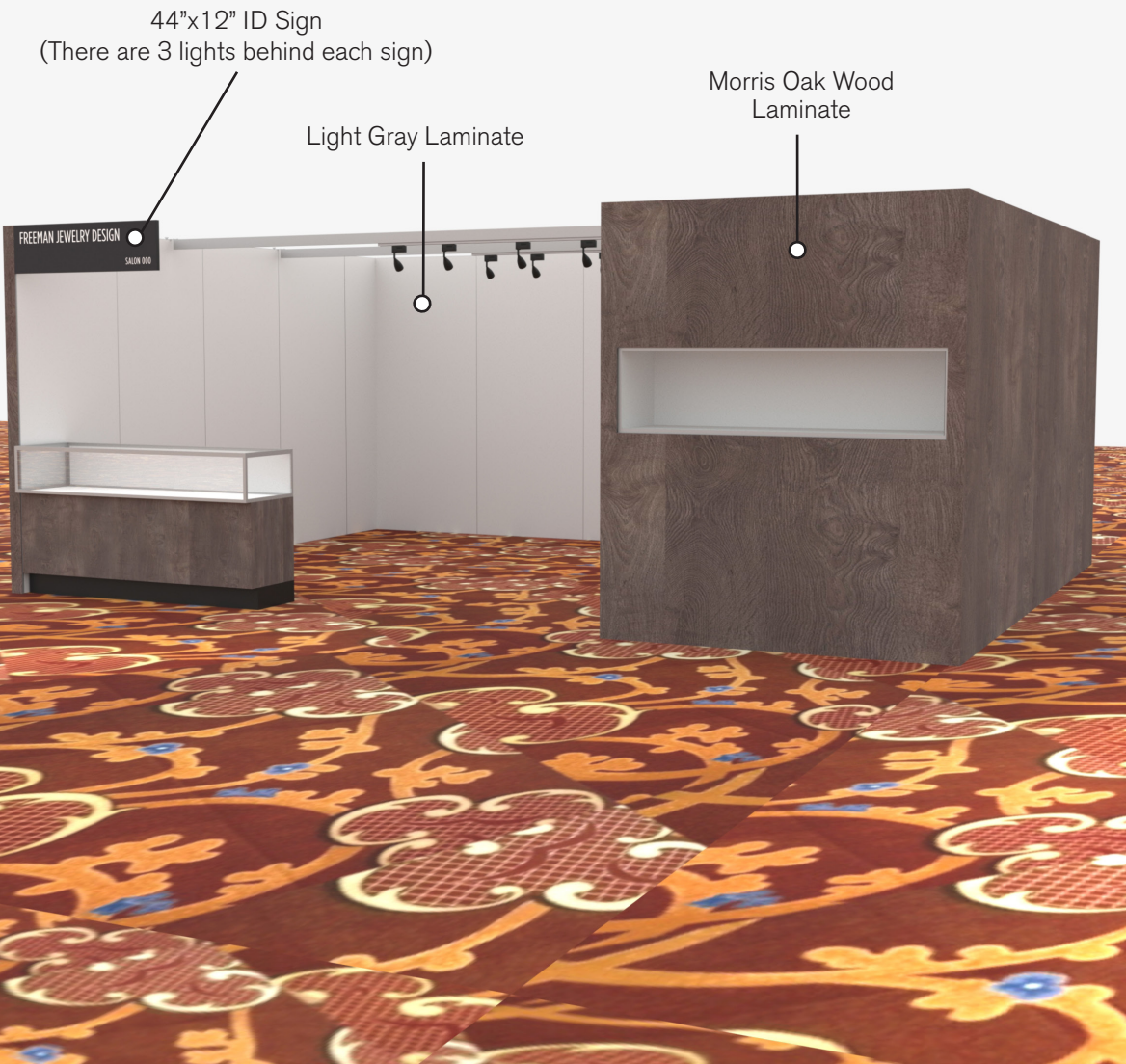

# 20x15 2M Tower and Showcase Option

44"x12" ID Sign

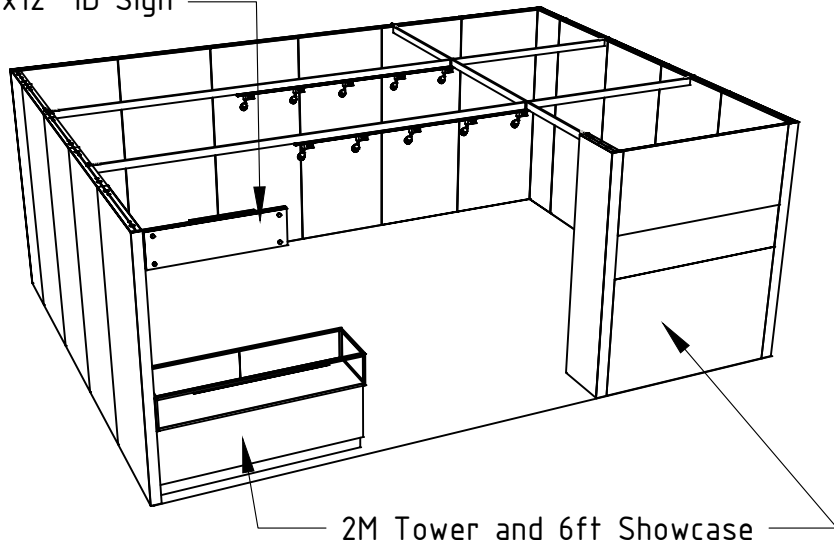

PERSPECTIVE - FRONT

2M Tower and 6ft Showcase

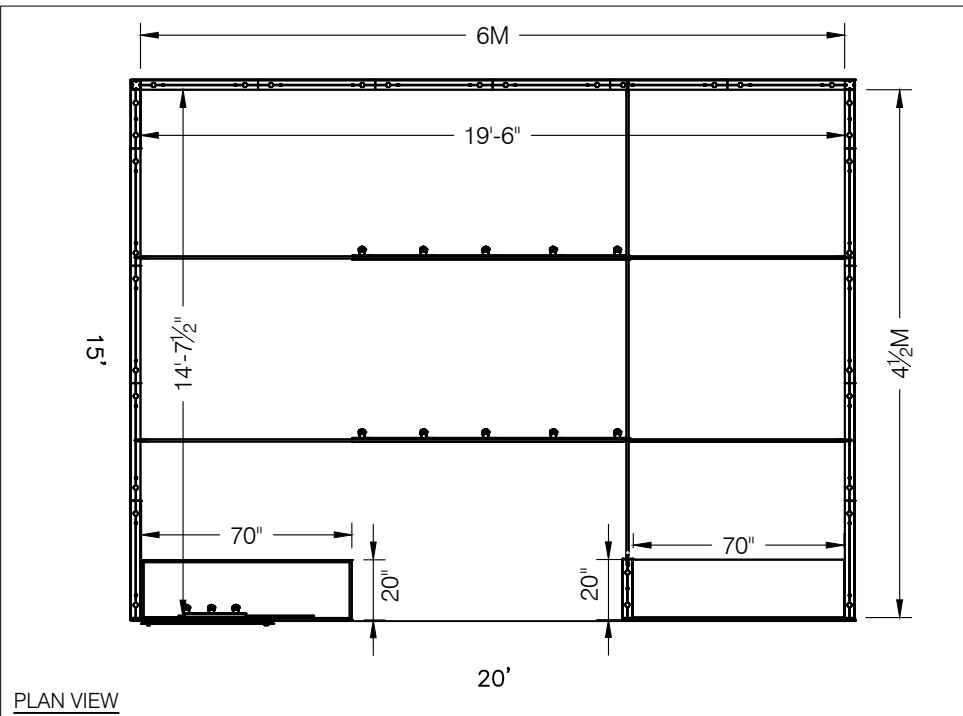

PLAN VIEW

Open space above showcase

13 Track Lights (Total)

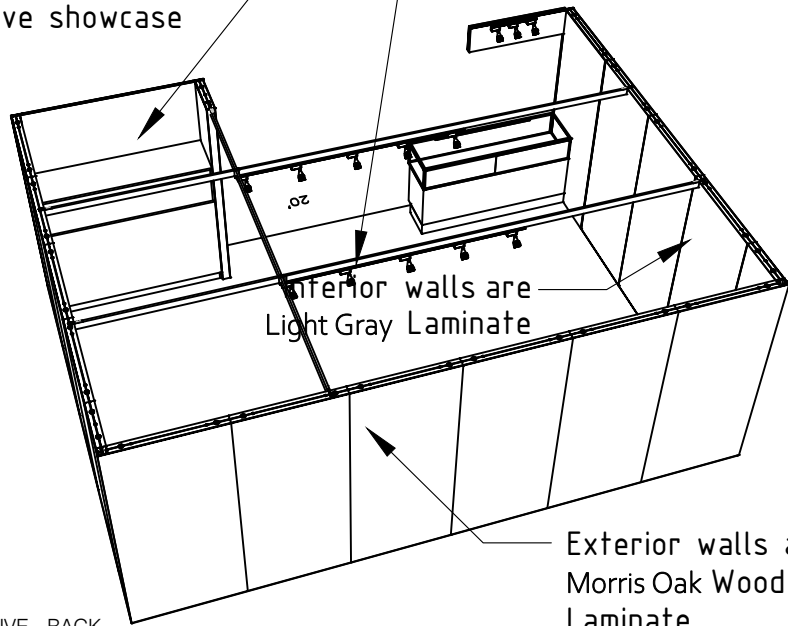

PERSPECTIVE - BACK

Interior walls are Light Gray Laminate

Exterior walls are Morris Oak Wood Laminate

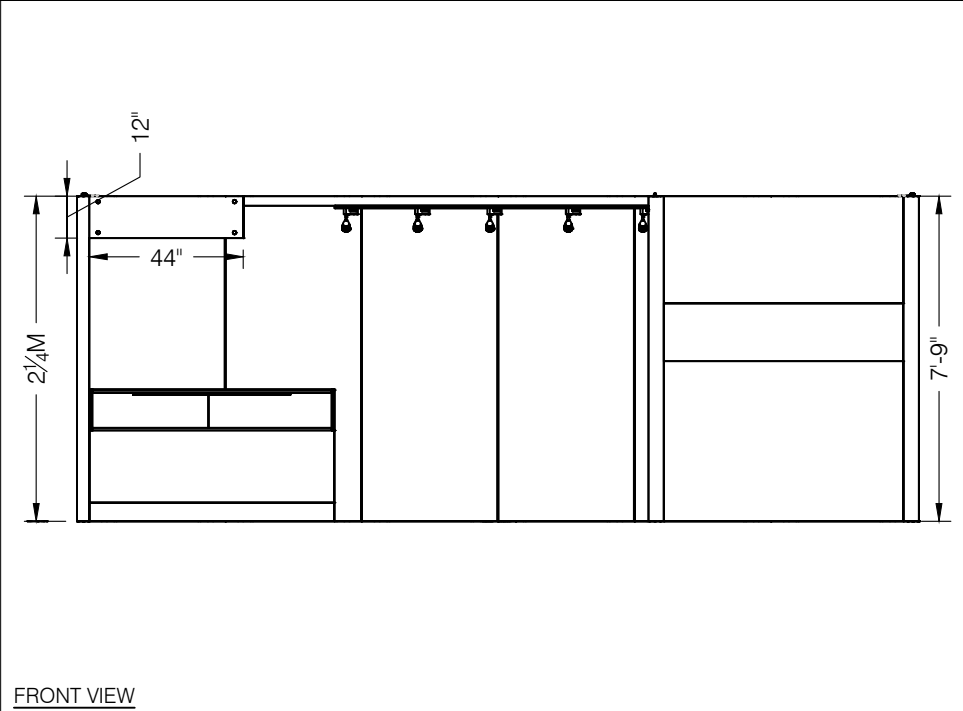

FRONT VIEW